

Stopgap Face Mask (SFM) - Bill of Materials

This bill of materials corresponds to **Revision A** of the Mask body and **Revision D** of the Filter Cover for the Stopgap Face Mask (SFM). The revision of the corresponding mask body and filter cover can be found on the front side of the mask as shown in Fig 1.

The Stopgap Face Mask consists of six different components. A diagram of the components is shown below in Fig. 1 and the list of components that make up each Stopgap Face Mask is included below.

1. 3D Printed **Mask Body**
 - Quantity: one [1] Mask Body
 - 3D printed material options:
 - i. 3D Systems - DuraForm ProX PA
 - ii. EOS - PA 1101 or PA 2200
 - iii. HP - 3D High Reusability PA 11, 3D High Reusability PA 12, or HP 3D High Reusability CB PA 12 (Monochrome)
2. 3D Printed **Filter Cover**
 - Quantity: one [1] Filter Cover
 - 3D printed material options:
 - i. Same as above
3. **Filter material**
 - Quantity: one [1] 2.25 in x 2.25 in patch
 - Cut patches from already approved surgical masks; one surgical mask can provide four filter patches for the SFM design
 - 3M 1832, 3M 1835 or equivalent
4. **Elastic Straps**
 - Quantity: two [2] separate 16 in long straps
 - Made from 1/8" wide flat braided elastic strap material
 - Conrad-Jarvis Corp. part # CCJ201 or equivalent
5. **Foam nose piece**
 - Quantity: one [1] strip 3 in long
 - 3/16 in thick 1/2 in width silicon foam strips with adhesive backing
 - McMaster-Carr part # 93415K51 or equivalent

Figures

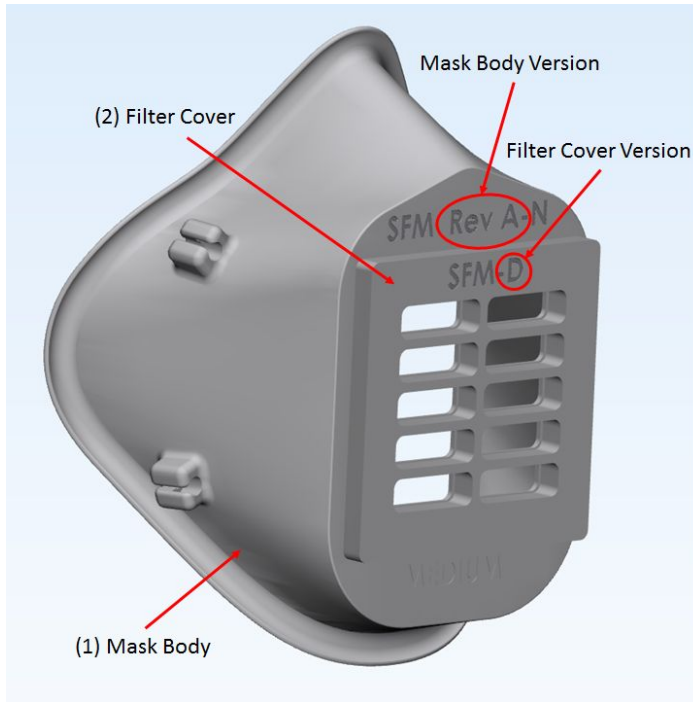

Fig. 1

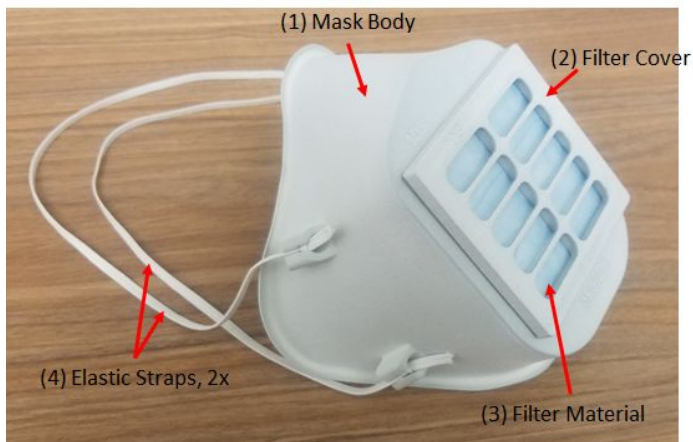

Fig. 2

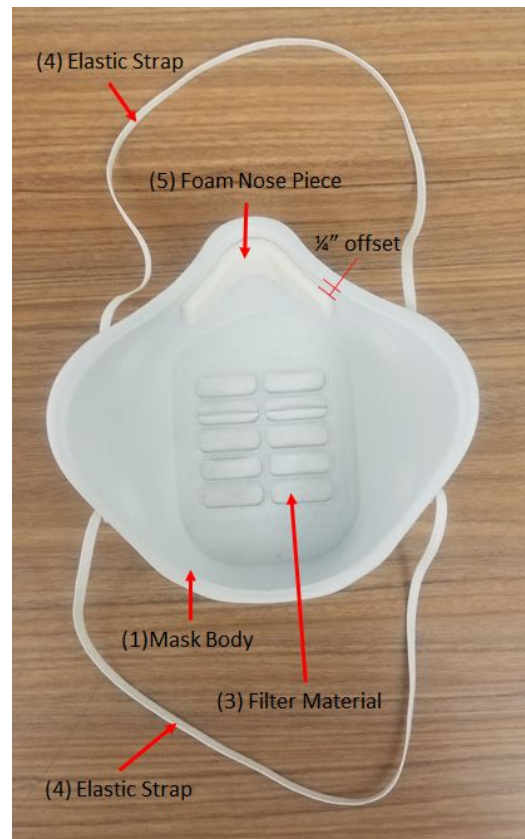

Fig. 3